



**Battery Steward® organizes your battery care schedule, alerts you when tasks are due, records maintenance and asset data, and allows you to analyze the data over time.**



## How does it work?

- Use your mobile device and identifying labels to create easy-to-follow battery care task lists. Tasks include watering, cleaning, and preventative maintenance.
- Check off batteries by scanning the Battery Steward identifying label that has been attached to your battery.
- Concerned about missing or overlooking a task? Battery Steward alerts you to when a task is due or past due.
- Record and analyze important battery maintenance data through the online portal.
- Identify neglected, misused, or abused batteries.

Download the app and create your account.



or visit [www.BatterySteward.com](http://www.BatterySteward.com)



# Quick Start Guide

Download the app and create your account.

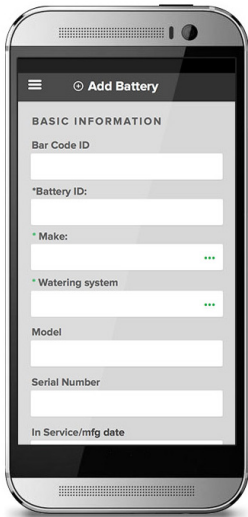

## ADD EQUIPMENT

Add batteries on your mobile device or through the batch-upload option on the web portal.

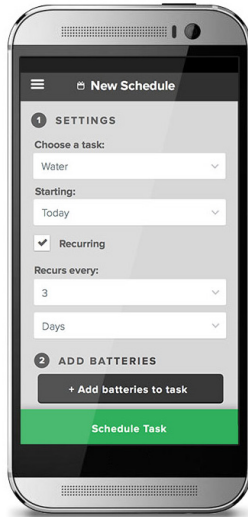

## SCHEDULE

Schedule batteries for maintenance.

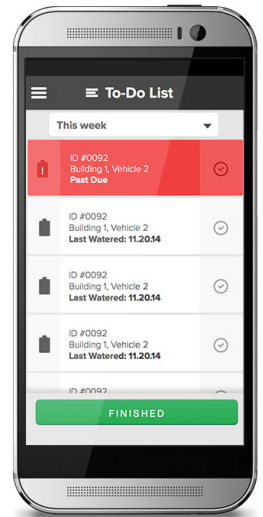

## TO-DO LIST

View your To-Do List to see past, upcoming, and future maintenance.



BatterySteward®

## TRACK YOUR BATTERIES

Apply a set of Battery Steward labels (FREE with Flow-Rite single-point watering kits) to 2 sides of each battery.

Check off your tasks by scanning the label with your mobile device or bar code scanner.